

HONEY

PLUG IN

Ultrasonic Diffuser

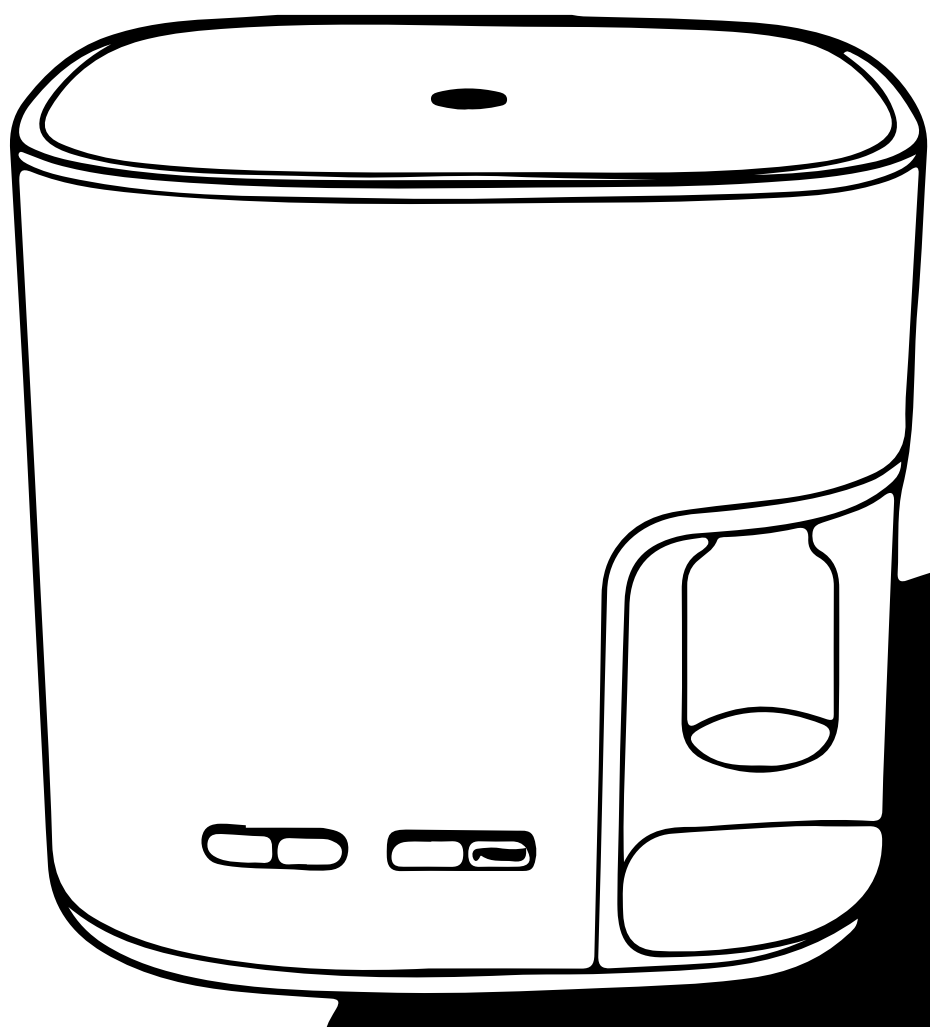

INTRODUCTION

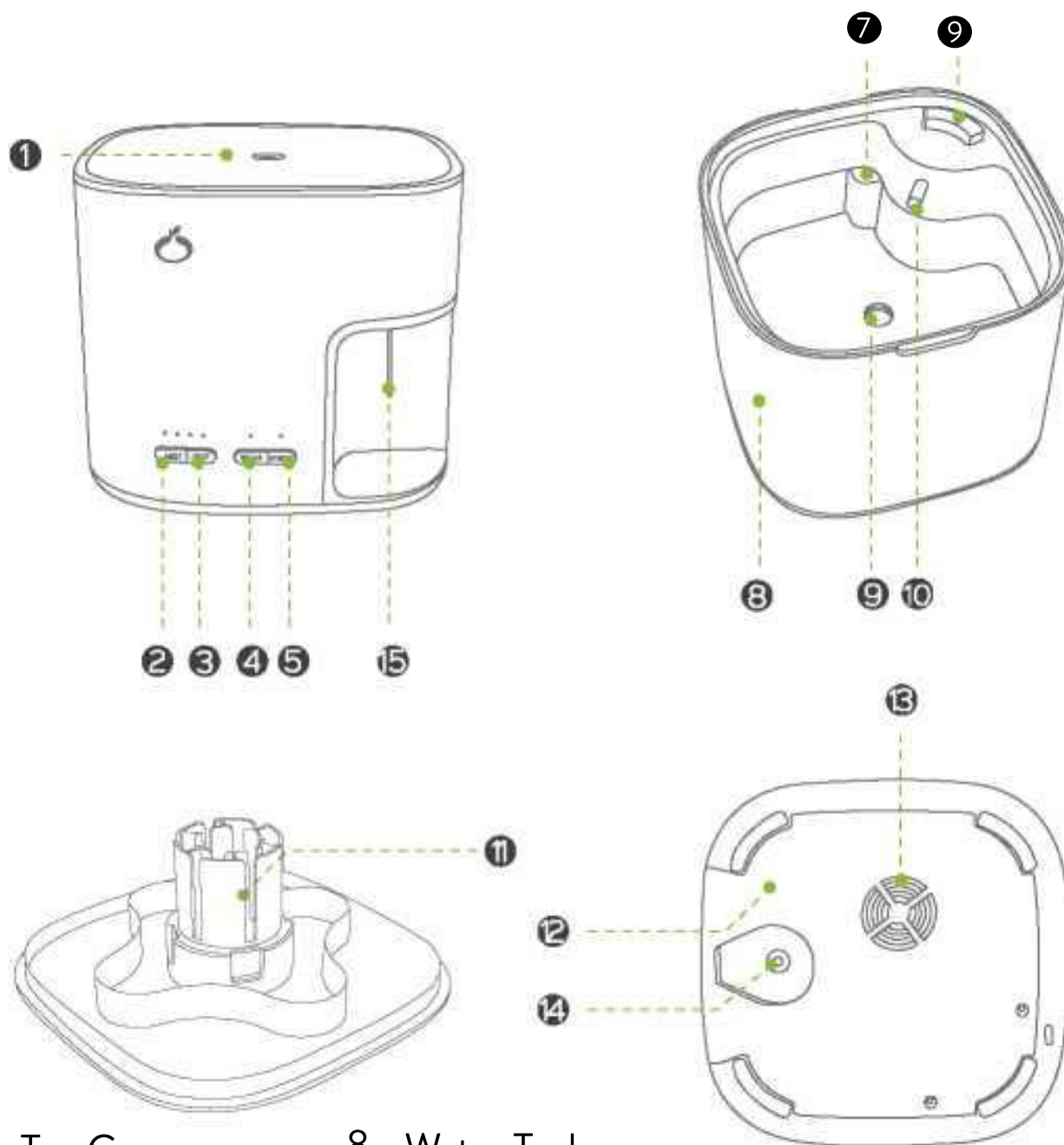

- | | |
|-------------------------|---------------------------|
| 1. Top Cover | 8. Water Tank |
| 2. ON/OFF Button | 9. Air Outlet |
| 3. Light Button | 10. Atomizer |
| 4. Oil Button | 11. Essential Oil Dropper |
| 5. Mist Button | 12. Base |
| 6. Essential Oil Intake | 13. DC Socket |
| 7. Max Water Line | 14. Air Intake Outlet |

OPERATION

Step1

Make sure the essential oil tube has been installed tightly

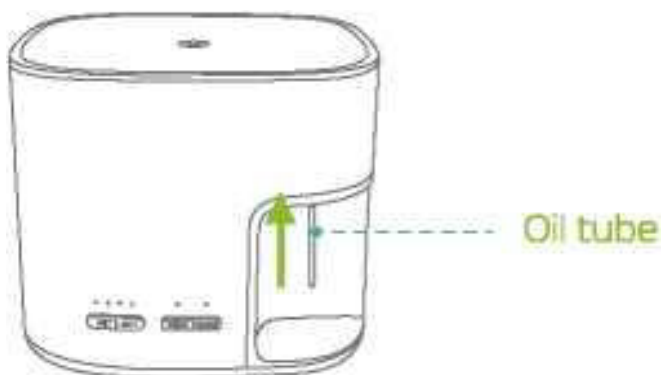

Step 2

Rotate and fix the attached oils to the diffuser. (Please fix tightly to prevent leaking)



Step 3

Connect the power with AC adapter.



Step 4

Add water into the water tank and do not exceed the max water line.

Max Water Line



Step 5

Place the cover and put it to a desired position.



Step 6

Push power button once, and push mist button once.



BUTTON FUNCTION

BUTTON

OPERATION



- 1st push turns on unit.
- 2nd/3rd/4th push toggles between timer lengths.
- 5th push, or push and hold turns off unit.



- 1st push turns on light, with color changing mode.
- 2nd push freezes color.
- 3rd-11th pushes manually change color.
- Push and hold turns off light.

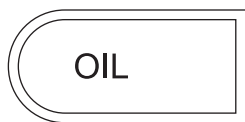

- 1st push auto dispenses oil every 3 hours
- 2nd turns off oil dispensing.
- Push and hold until a long beep sounds to add additional oil manually. Autodispensing schedule will continue.



- 1st push keeps unit in regular mist output
- 2nd push turns on higher mist output

MAINTENANCE

For the best maintenance, we suggest you empty the residual liquid and clean the tank before refilling, changing oils, or not using the unit for an extended period. Suggested steps for cleaning are:

1. Turn off and unplug the unit.
2. Remove the lid, then remove any remaining water from the tank.
3. Run the cover under warm water and use gentle soaps for any deep cleaning needs.
4. To clean the rest of the unit, and inside the water tank, use a cotton swap or dmple towel to wipe away any residue. Diluted vingar can be use to deep clean the water tank as needed.

Warning: Only empty water away from the air outlet. Getting water inside the air outlet can damage the unit.

TROUBLESHOOTING

Please refer to the table below in the event of the product operating abnormally:

Will not switch on/off	1) Is there enough water in the tank? -- If not, please add water to the tank. 2) Is the power cord connected properly? -- Verify by disconnecting, checking the cables, then re-connecting carefully.
No mist or abnormal mist	1) Is the water level correct? --If not, adjust the amount of water in the tank 2) Is there build up on the atomizing plate or dust on the air intake on the bottom? --If so, please clean the unit following the Maintenance instructions 3) Is the cover or plastic lid not installed correctly? --Verify by removing these pieces and reassembling them according to the Operation instructions. 4) Is the unit on intermittent mode? --If so, adjust the mode to continuous mode using the right "Mist" button.
No Light	1) Is the power cord connected properly? -- Verify by disconnecting, checking the cables, then re-connecting carefully. 2) Has the light function been engaged? --If not, press the left "Light" button on the unit. There are multiple light color options and you can cycle through them by continuing to press this button until the light turns off.

For any other issues, please contact hello@revive-eo.com.

SPECIFICATIONS

Dimensions	Approx 63 x 63 x 52MM
Weight (excluding adaptor)	Approx 15oz
Power Rating	DC24V -0.5A
Power Consumption	Approx 10W per hour
Working mode	Continuous/Intermittent
Tank Capacity	500ML
Light	LED
Material	BPA-Free Plastic
Mist Output	20-40ml/hr
Working time	10-16 Hrs

SAFETY

Please read all the instructions before using this product.

- In cases of abnormal unit performance, unplug the unit and contact us at hello@revive-eo.com.
- Always clean regularly as per maintenance instructions.
- Always keep on a stable flat surface when in use.
- Never attempt to disassemble or repair the product. If internal inspection or repair is needed please contact us at hello@revive-eo.com.
- Please keep out of reach of children to reduce the risk of injury.
- Never cover or surround unit with cloth or blankets while in operation.
- Do not immerse in water

For optimal use, please follow the following recommendations:

- Do not fill water above the MAX water line
- Do not use hot water
- Do not add water while the unit is running
- Best use with REVIVE Essential Oils