

REVIVE

Oasis Ultrasonic Diffuser



1 Introduction

By breaking up the mixture of water and essential oil into millions of micro-particles, a stream of air diffuses the activated ingredients in the essential oil, which can easily be absorbed by the body and freshen the room. By adopting aromatherapy principles, your body will be gradually relaxed and your senses will be invigorated.



2 Specifications

Product name: Oasis Diffuser
Product Size: 107mm X 212mm
Voltage: DC 24V
Power: 12W
Water Capacity: 100mL
Coverage: 250 sq.ft.
BPA-Free Polypropylene plastic

1. Cover
2. Diffusion Vent
3. LED Light
4. Max Water Level Line
5. Water Tank
6. Ceramic Disc
7. ON/OFF Button
8. Adapter

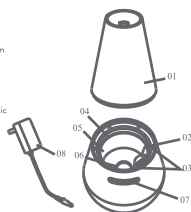

3 Operation

Ultrasonic Technology:
Our diffusers run through vibrations (2.5 million vibrations/second) instead of emitting heat. This means the plastic, water, and oils are never heated while diffusing, and that the plastic never interacts with the essential oils.

Safety-off switch:
No need to worry about whether you left your diffuser on — it will automatically turn off once it has run through its timed setting or is out of water.

BPA-Free Plastic:
The water reservoirs and plastic lids inside our diffusers are made from high grade, BPA-free plastic



1. Remove the cover



2. Fill the water tank with water (max. 100ml).



3. Add 5-12 drops of REVIVE Essential Oils into the water.



4. Replace the cover

5. Press Button:
a. 1st Press - Mist ON & LED ON
b. 2nd Press - Mist ON & LED OFF
c. 3rd Press - Unit Off

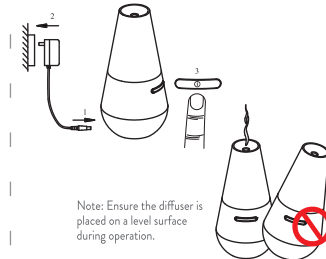

4 Maintenance



1. Press the (I) button to turn the unit off and unplug the adapter.



2. Remove the cover



Warning:
Do not empty water from the front side.



3. Use a clean swab or cloth to clean the unit. At least once per 3 days is suggested.

Note: For pure fragrance effect, it is suggested to empty the residual liquid and clean the tank before refilling, changing oils, or not using the unit for an extended period.



5 Troubleshooting

Symptom	Possible Cause	Solution
No Mist	Diffuser Won't Turn On	Try plugging the diffuser into a different electrical outlet and press the power button.
	Oil is Not Diffusing	Ensure the water tank is filled with 30-100ml of water.
	A Film Substance is on the Cover	Clean diffuser thoroughly with cotton swab before next use.
	LED Light & Mist is Not Turning On	



6 Warning

In the case of abnormal situations such as smoke, peculiar smells or excessive noise, any further use may result in an accident such as fire or electric shock. You should unplug the adapter immediately and contact us at hello@revive-eo.com.

Never wrap the adapter with a cloth or paper. Doing so interferes with the unit's ability to properly dissipate heat, which may lead to melting or fire.

Never attempt to disassemble or repair the product. In case of internal inspection or repair needed, please contact us at hello@revive-eo.com.

Please keep the product out of the reach of children to avoid injury or electric shock.

Table of Contents

1. Introduction
2. Specifications
3. Operation
4. Maintenance
5. Troubleshooting
6. Warning

Get in Touch

Our team would love to chat or help with anything we can!

Email us at hello@revive-eo.com